

Contact Information

See the other side of the newsletter for the factory trained sales organization near you!

main telephone: 315-782-2350
main fax: 315-788-1180
www.northlandmotor.com

PATENT HISTORY 100 YEARS AGO

Engineering

Patent 861799 was issued on July 30, 1907 to Robert Breil for the Metal Rule. Mr. Breil's design included slots cut through the rule so "to display the article upon which it is used, that the measurement may be registered or checked upon the article being measured, by marking on through properly shaped openings".

Electric Motor

Patent 874430 was issued on Dec. 24, 1907 to Thomas Pither of Western Electric Company for a variable speed ceiling fan motor incorporated into the fan housing. The variable speeds were the result of a system of gears. Variable speed is a little easier today, with NMT BLDC drives and motors!

NMT INTRODUCES 4.3" BLDC MOTOR

The 4.3" BLDC motor was developed for higher temperature applications such as commercial food prep equipment, processing oven blowers, and laboratory equipment. A major OEM of processing ovens approached NMT with the need for a blower motor and drive. The application required the motor to operate at 2 specific fixed speeds, and to be able to run 24 hours a day, while mounted to the back of an oven.

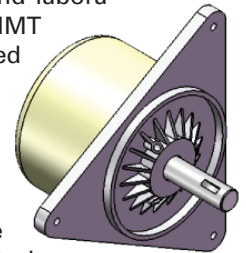

NMT's solution was a new 3 phase motor that features variable or multiple fixed speed capability with high operating efficiencies. Compatible with NMT's AC input BLDC drives, the combined package offers either open loop or closed loop control.

The 4.3" motor is the third new product to be launched by NMT's Watertown, New York Research and Design Facility this year.

NMT DEVELOPS 100 VOLT AC BLDC DRIVE

The new drive was developed for a medical equipment OEM seeking to expand their market share in Japan. The design criteria was to develop a drive for use with an existing pump, designed for the North American market. Naturally the new drive had to deliver the same speed range and performance levels as the North American product, but with only 100 Volts input. In addition to the design criteria, NMT worked closely with the customer to ensure the product met the applicable industry standards in Japan. "We accelerated it to a 60 day program with the assistance of our customer. Our Customer included NMT as part of the overall product development team, along with their Japanese customer. We were able to address design issues and market requirements in a time effect manner. There's no better way to develop a new product than sitting at the table with the OEM and their customer." stated Mike Coles NMT's Director of Engineering.

TWO MORE FIRMS JOIN THE NMT SALES TEAM

NMT continues to expand their network of sales professionals with the addition of ServiCon Sales Corp. and Clarkson Company, Inc.

ServiCon Sales Corporation was founded in 1987 by Carlton Bryant. Heritage Sales Associates, Inc. was founded in July, 1981 by Darrell Johnson. Because of a strong synergy and product line mix, the two companies merged in 1999. ServiCon sells Industrial Electrical, Electronic and Mechanical Equipment to Distributors, OEMs and End Users located in North Carolina, South Carolina, Georgia and Virginia.

Clarkson Company, founded in 1956 by Walt Clarkson, specializes in technical sales of custom and standard mechanical and electromechanical products to the OEM and distributor markets. Clarkson's home office is in Hoffman Estates (Chicago), Illinois with branch offices in Brookfield (Milwaukee), Wisconsin and Cedar Rapids, Iowa. Clarkson Company's Sales Engineers service customers in Illinois, NW Indiana, Wisconsin, Iowa, Nebraska, Minnesota, the Dakotas and Missouri.

